

- KEY
- Site boundary
  - Services
  - Parking
  - Storage areas
  - Deep soil
  - Waste rooms

## Basement Level 01

Approximately 58-62 car spaces\*\*

\*\* Pending accessible spaces

18054 - PP - Bexley North - 187 Slade Road

Concept plans (to scale)

Prepared for: TUNBORN PTY LTD

SK-001

Revision: B by DR

Issued on 22 July 2020

SCALE: 1:500 @ A3\*



\*Please note subject any printing margins

© GM Urban Design & Architecture Pty Ltd | All Rights Reserved.  
All methods, processes, commercial proposals and other contents described in this document are the confidential intellectual property of GM Urban Design & Architecture Pty Ltd and may not be used or disclosed to any party without written permission.

Nominated Architect - MS Gabrielle Morrish

Level 8, 75 Miller Street  
North Sydney NSW 2060  
Tel (02) 8920 8388  
Web [www.gmu.com.au](http://www.gmu.com.au)

**GMU**  
Urban Design & Architecture

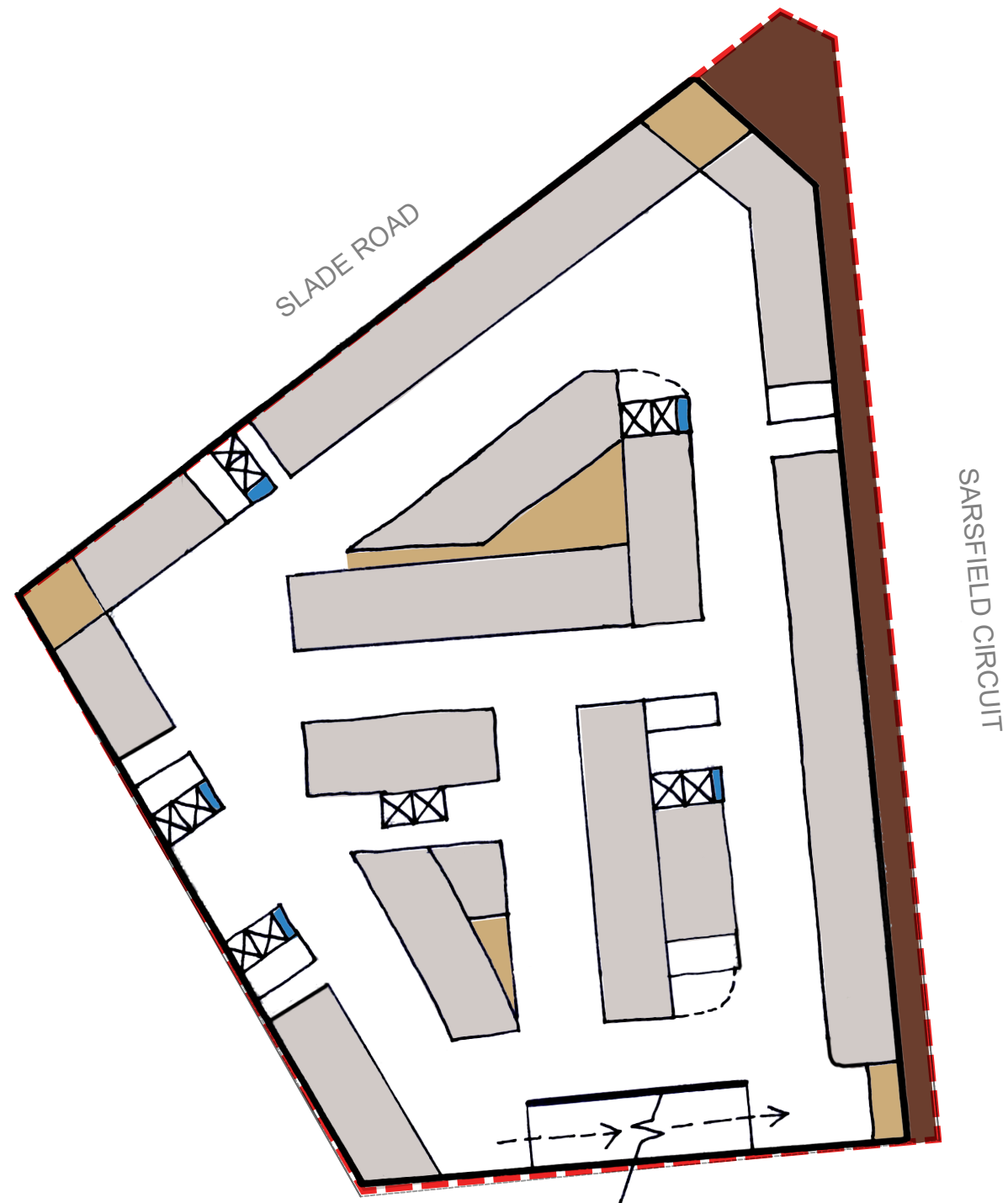

- KEY
- Site boundary
  - Services
  - Parking
  - Storage areas
  - Deep soil

## Basement Level 02

Approximately 108-110car spaces\*\*

\*\* Pending accessible spaces

18054 - PP - Bexley North - 187 Slade Road

Concept plans (to scale)

Prepared for: TUNBORN PTY LTD

SK-002

Revision: A by DR

Issued on 25 March 2020

SCALE: 1:500 @ A3\*



\*Please note subject any printing margins

© GM Urban Design & Architecture Pty Ltd | All Rights Reserved.  
All methods, processes, commercial proposals and other contents described in this document are the confidential intellectual property of GM Urban Design & Architecture Pty Ltd and may not be used or disclosed to any party without written permission.

Nominated Architect - MS Gabrielle Morrish

Level 8, 75 Miller Street  
North Sydney NSW 2060  
Tel (02) 8920 8388  
Web [www.gmu.com.au](http://www.gmu.com.au)

**GMU**  
Urban Design & Architecture

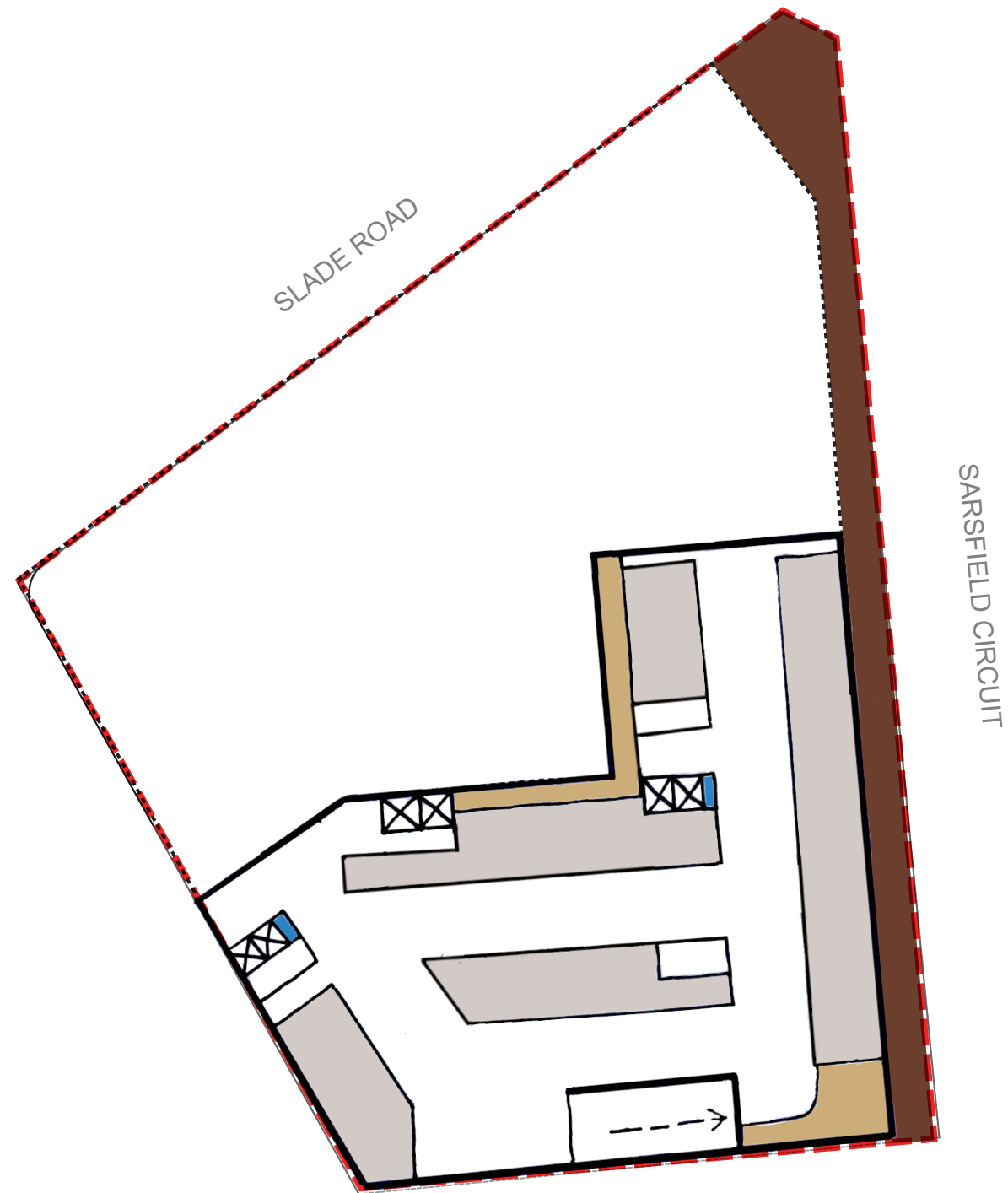

- KEY
- Site boundary
  - Services
  - Parking
  - Storage areas
  - Deep soil

## Basement Level 03

Approximately 40-42 car spaces\*\*

\*\* Pending accessible spaces

18054 - PP - Bexley North - 187 Slade Road

Concept plans (to scale)

Prepared for: TUNBORN PTY LTD

SK-003

Revision: A by DR

Issued on 25 March 2020

SCALE: 1:500 @ A3\*



\*Please note subject any printing margins

© GM Urban Design & Architecture Pty Ltd | All Rights Reserved.  
All methods, processes, commercial proposals and other contents described in this document are the confidential intellectual property of GM Urban Design & Architecture Pty Ltd and may not be used or disclosed to any party without written permission.

Nominated Architect - MS Gabrielle Morrish

Level 8, 75 Miller Street  
North Sydney NSW 2060  
Tel (02) 8920 8388  
Web [www.gmu.com.au](http://www.gmu.com.au)

**GMU**  
Urban Design & Architecture